



Livingponds® Pressure Filter with Springflo Bio Filter Media

Operating Manual & Specifications

Read the entire instructions prior to assembling and operating



Models Numbers

- LP1000
- LP2000
- LP3000
- LP4000

Read entire instructions prior to assembly and operation

Introduction



PLEASE READ THIS MANUAL SAVE FOR FUTURE REFERENCE

THE INSTRUCTIONS AND WARNINGS HEREIN PRESUME EXISTING FAMILIARITY WITH THE DESIGN AND FUNCTION OF THESE AND SIMILAR PRODUCTS AND THEIR COMPONENTS.

The model(s) represented in this manual may have additions and/or modifications made at any time. Pictures represent a standard unit series and an actual unit may vary slightly. This manual is based on the latest products' information available at the time of creation or last revision. It is believed to be generally accurate and reliable. Please consult our customer service representatives here at Savio Engineering if detailed information is desired, or whenever there is a question about a given unit's configuration or performance specifications at **(888)333-2356**.

Livingponds PRESSURE FILTER MODEL CHART

Livingponds Series Model #	Rated Voltage / Hertz	UV Watts	Rated Current Input (Amps)	Maximum Pump Size (GPH)	Maximum Water Garden (Gallons)	Maximum Fish Ponds (Gallons)
LP1000	120V, 60Hz	9	0.075A	1,000	1,000	500
LP2000	120V, 60Hz	13	0.108A	2,000	2,000	1,000
LP3000	120V, 60HZ	24	0.2A	3,000	3,000	1,500
LP4000	120V, 60Hz	36	0.3A	4,000	4,000	2,000

Congratulations on your purchase of **Savio's Livingponds Series Pressure Filter**! Thank you for being a valued customer! We are grateful for the opportunity to provide you with superior products, such as a Livingponds Series Pressure Filter that is manufactured to the highest standards using quality materials.



MISSING PARTS?

THERE IS NO NEED TO RETURN THIS PRODUCT TO YOUR RETAILER.
CALL US AT (888)333-2356
AND **WE WILL MAKE IT RIGHT!**

Safety First

It is recommended that you thoroughly read and understand this manual prior to first startup and before you attempt to service the model to which **Livingponds Series Pressure Filter** this applies. If you have any questions, we'll be happy to help. Please call us, at **(888)333-2356**.

THE FOLLOWING CAUTIONS AND WARNINGS ARE FOR YOUR OWN SAFETY!



Attention: This filter is not intended for use by persons, (including children) with reduced physical sensory or mental capabilities, or lack of experience and knowledge, unless they have been given supervision or instruction concerning use of the pressure filter by a person responsible for their safety.



This filter is designed to be used outdoors, but does **not** require to be submerged.



Never plug-in, or otherwise use this product, if any part of it appears to be damaged or operates abnormally. If you need help troubleshooting, please call us at (888)333-2356.



Never operate this pressure filter connected to any voltage other than that shown on the pressure filter.



This pressure filter is designed to be earthed.



Never leave children unattended around this pressure filter while operating.



Always have this pressure filter connected to properly grounded GFCI electrical outlet **only**! A "hard-wire" installation will result in your warranty being voided.



Always disconnect from electrical supply before handling, or maintenance or troubleshooting is performed on your pressure filter.



The **UV light** needs to be turned "**OFF**" when there is no water inside your pressure filter to avoid overheating.



Avoid direct contact to your skin and exposure to your eyes from the **UV** light. It can be extremely harmful and will result in injury.



Attention: Do not operate this pressure filter under any condition other than those for which it is specified. Failure to observe these precautions can result in serious injury and will void the warranty!



WARNING



ELECTRICAL SHOCK HAZARD

This product must be properly grounded!

Do not modify the plug provided. Only plug into a GFCI electrical outlet. If you do not have a GFCI electrical outlet, we recommend you have one properly installed by a qualified electrician!

If the cord should ever need a repair or replacement, please contact Savio Engineering's Customer Service Representatives for further instructions on how to have your product serviced. **NEVER** modify the cord or plug on your product!

Be sure that your source of power is correctly wired and in proper operating condition. Never hard-wire or permanently connect this product to a power source!

Failure to follow these instructions can result in fire, a serious injury from electrical shock, or even death!

Remember, Correct Installation Is Your Responsibility!

Make sure you have the proper installation conditions. The **Livingponds Series Pressure Filter** needs to be protected from any objects/debris during operation. Before beginning assembly or operation of product, make sure all parts are present.

If **any** part of your **Livingponds Series Pressure Filter** is *missing* or *damaged*, **do not attempt to assemble, install, or operate.**

Plumbing

For maximum water flow, it is recommended that the largest tubing size for your pressure filter is used during your installation. Selecting the correct tubing for your project is crucial for the durability of the installation. We highly recommend using our **FreezeFlex** tubing!

FreezeFlex is ideal for ponds and waterfalls requiring quality high-strength flexible tubing that resists kinking and collapsing.

FreezeFlex withstands freezing without compromising structural integrity or strength of the hose.



This pipe is ideal for ponds and waterfalls requiring high-strength flexible hose that resists kinking, collapsing, and withstands freezing without compromising structural integrity or strength of the FreezeFlex hose.



Electrical Requirements

This pressure filter is rated at 120 Volts 60Hz. Only use a power supply rating voltage at 120 volts and 60Hz, which complies with that listed on label on the **Livingponds Series Pressure Filter**. The cord must be plugged into a GFCI outlet that is properly installed and grounded in accordance with all local codes and ordinances.

A hard-wired installation is **not** recommended and **will** result in the warranty being voided!

It is your responsibility to contact a qualified electrician and assure that the electrical installation is adequate and in conformance with all national and local codes and ordinances. Make sure this pressure filter is securely installed before any operation.

EXAMPLE OF A GFCI OUTLET
(GROUNDED FAULT CIRCUIT INTERRUPT)

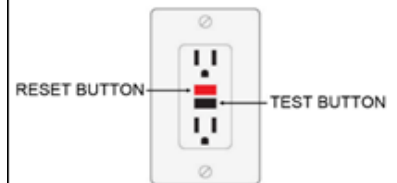

How the Livingponds Series Pressure Filter Works

Stage1 – Mechanical Filtration

Water is pumped into the Livingponds Series Pressure Filter creating the necessary pressure to begin the mechanical filtration stage. There is a series of ribbons specially designed to effectively remove all sizes of unwanted debris.

Stage 2 – Biological Filtration

There is a large number of biochemical ribbons (Springflo) inside your Livingponds Series Pressure Filter where the biological filtration stage begins. This stage uses Springflo providing a habitat for beneficial bacteria to grow. These bacteria naturally convert harmful ammonia and other wastes into healthy nitrates that fertilize aquatic plants and support a healthy pond environment.

Stage 3 – UV Filtration

The final filtering stage uses an Ultra-Violet (UV) Light located in the middle of your series of filters. Exposure to the UV light helps clarify as the water passes upward through the filter on its way back to your water feature.

Operation

- It is easy to clean the filter! Simply lift the handle and pull the drawbar up and down to agitate the filter media, the machine will self-clean and purge the Springflo within while running the "backwash" function of your pressure filter.
- The clear small window on the filter allows you to monitor easily, and safely, when the UV lamp is operating.
- The pressure filter should not be susceptible to damage from any loose debris, mud, or rocks in the pond to prevent the filter from becoming prematurely clogged or cause serious damage to your pressure filter, or any fish you may have in your pond.
- The electrical connection should be secured in a water-proof place and should be at least 6 feet (2 meters) away from the water feature. Ensure that the cord loops below the electrical outlet to form a "Drip Loop". This will prevent water from running down the cord into the electrical outlet.
- The pressure filter can be switched on by simply plugging it in and switched off by un-plugging it.
- A routine maintenance schedule is critical for proper operation of your pressure filter and will give it a longer operational-life.
- When adding bacteria to your pressure filter, make sure your UV Bulb is turned off for 48 hours.
- If you have any other questions about your Livingponds Series Pressure Filter, call us at (888)333-2356. We will help!

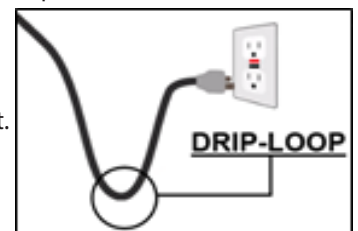

Installation

Choose suitable place to install the Livingponds Series Pressure Filter. You will need to dig a six-inch-deep channel connecting the pressure filter and upper pond basins. This channel will allow you to bury and conceal the tubing once connected. You will also need to create a hole to partially bury the pressure filter. While keeping it in an upright and level position, the pressure filter can be buried in the ground up to the pressure filter's clips/clamp.

Connect your pump to the pressure filter tubing connector barb marked by the symbol "inlet" arrow with flexible hose. Lay the hose in the channel. Attach the tubing to the filter's connector marked by the symbol "outlet" arrow and lay it in the channel leading to the upper pond basin. You should use stainless steel clamps to create a water tight seal at all your tubing connections (filter and pump). The correct functioning of the UV Bulb is indicated by the lighting visible on the top of the outer lid. After submerging the pump in water, plug-in both the pump and pressure filter to check their performance.

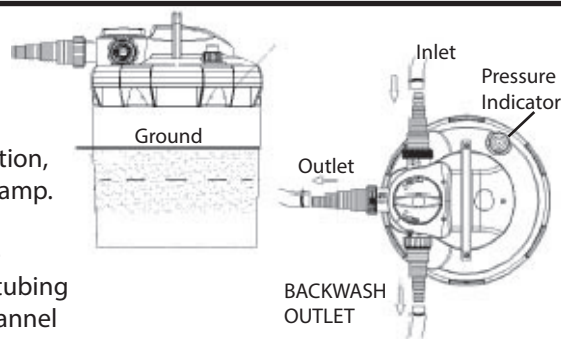

Pro Tip: When using our FreezeFlex pipe or any other "hard" pipe, we recommend using the appropriate sized unions during your installation, so the lid of the pressure filter can be easily removed. For more information on this installation method, please refer to our website at www.savioeng.com

Maintenance

Your pressure filter is designed to let you know when filtration performance declines. Your filter is equipped with a color-coded "pressure indicator" located on the container lid. When your pressure filter is operating effectively, the pressure indicator will display GREEN. If the flow rate within your pressure filter drops the pressure indicator will display RED.

It is your responsibility for upkeep on the maintenance on your Livingponds Series Pressure Filter. You must conduct regular routine inspections and make necessary repairs to your pressure filter in order to maintain proper operations.

Make sure the to monitor the Springflo within periodically. Ensure the filter media is kept clean from large debris. This will allow water to flow unrestricted into the pressure filter chamber. You do not want to over-clean your media, as you may harm the beneficial bacteria growing on the surface area of your filter media. The Springflo should only be cleaned if they are highly contaminated and you should use pond water only to preserve the beneficial bacteria and keep the filter biologically active. Every water feature is different; learn how frequently your pressure filter needs to be cleaned to allow unrestricted water flow. Pressure filters that run "dry" and become damaged due to restricted water flow are not covered under the terms of the warranty. Always follow the safety instructions and make sure that the pressure filter is disconnected from the power supply before attempting to perform maintenance on your pressure filter.

The pressure filter can be opened and the individual components within can be cleaned manually. If this option of cleaning is performed, we recommend cleaning the components to a point, so they can perform the way intended. Do not over-clean your pressure filter's components! This will kill all the beneficial bacteria that is growing to help with the biological filtration. Unlike poly fiber filters that need to be changed regularly, Springflo lasts indefinitely so there is no need in replacing your Springflo filter media. Should you need to replace your media, pack your Springflo Filter media loosely, not tight, for best performance.

Changing the UV Bulb

If your pond water is turning green in color, make sure your UV Bulb is turned on. If your UV Bulb has been installed for 9 months or is no longer producing UV Rays, it may need to be replaced.

To change the UV Bulb, first unplug the pump and pressure filter from their power sources. Pull the drawbar to the top, loosen the three screws on the cover, and remove the cover. Rotate the lid cover, until the arrows on the lid cover aim at the arrow on the ring holder. Remove the cover from the top of the pressure filter's lid. Unscrew the UV light assembly counterclockwise and gently lift out. Allow UV Light Ballast and UV Bulb to cool and dry completely before handling. While waiting for the UV Bulb and Ballast to cool, properly clean the glass quartz tube where the bulb is placed. Loosen the fixed nut and remove the central tube which connects to the lid, extract the glass tube, remove possible calcareous deposits on the tube. When the Glass Quartz Tube is cleaned properly, replace it back into your pressure filter. Your UV Bulb and Ballast should be cool and dry now. Grip the base of the UV Bulb with a dry cloth and gently pull the bulb from the Ballast (do not pull on the bulb by gripping the glass element). Slide new UV Bulb into place until properly seated. Do not test UV light until the filter has been reassembled ensuring the O-rings and gaskets are correctly placed! We recommend replacing your UV Bulb every 9-16 months. Never look directly into your UV Bulb! If you are having issues replacing your UV Bulb, please call us at (888)333-2356.

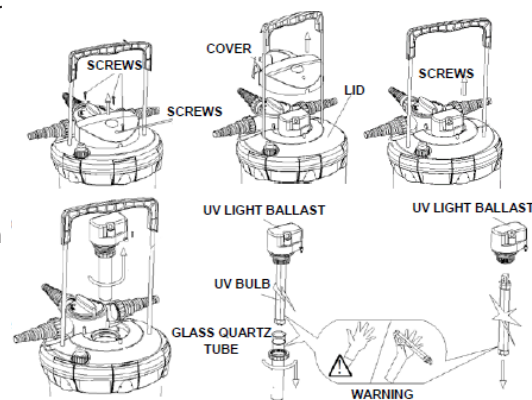

This image shows a full page of white paper with horizontal blue or grey ruling lines. The lines are evenly spaced and run across the width of the page, providing a template for handwriting practice or general note-taking. There are no margins, text, or other markings on the page.

This image shows a full page of blank, lined paper. It features approximately 28 evenly spaced horizontal black lines across its entire width, providing a template for handwriting practice or general note-taking. The margins are consistent on all sides.

Warranty

Savio Engineering provides a manufacturer's limited warranty of 2 years from original purchase date. Warranty does not cover consumables or wear items. Warranty is non-transferable. Within the warranty period, Savio will repair materials with manufacturing deficiencies at their discretion.

This warranty does not cover and faults caused by improper use, installation and handling of the device or as a result of wear and tear. Savio Engineering does not assume liability for consequential damage caused by the failure of the product.

Removal of cord or ground-pin voids warranty. Warrant is void if the product is not used in accordance with instructions. For warranty claims, please contact your dealer or place of purchase.

Innovative, precision-engineered solutions

Advanced water gardening products for healthy, clean Livingponds.

